



# CONGRESSIONAL TOUR

*Washington, D.C.*

*February 22-26, 2020*

**KFB100YEARS**  
— EST. 1919 —



# TABLE OF CONTENTS

KFB-DC

02.22-26.20

**AGENDA .....4-7**

- Daily Agenda
- Shuttle Information

**KENTUCKY’S CONGRESSIONAL DELEGATION.....8-11**

- Kentucky Congressional Districts Map
- United States Senators
- United States Representatives

**KENTUCKY FARM BUREAU NATIONAL PRIORITIES .....12-15**

- National Farm Policy
- Trade
- Infrastructure
- Regulatory Reform
- Immigration & Farm Labor Reform
- Health Care Reform
- Fiscal Policy
- Wildlife Issues

**ADDITIONAL INFORMATION.....16-18**

- Hospitality
- KFBF Staff Contact Information
- Hotel Information
- Hotel Floor Plan

# TOUR AGENDA

KFB-DC

02.22-26.20

## SATURDAY, FEBRUARY 22

9 AM-5 PM **Hospitality Room**  
JW Marriott | Senate Room, Lobby Level

---

## SUNDAY, FEBRUARY 23

8 AM-5 PM **Hospitality Room**  
JW Marriott | Senate Room, Lobby Level

8:30 AM **Guided City Tour**

10:15 AM **Smithsonian National Air & Space Museum**

1:00 PM **Arlington National Cemetery**

---

## MONDAY, FEBRUARY 24

8:30 AM **Group Meeting**  
Capitol Ballroom, Salons FG  
Presiding: Mark Haney, President, KFB

**AFBF Briefing**  
Paul Schlegel, Vice President, Public Affairs, AFBF

**KFB Briefing**  
Emily Buckman, Director, National Affairs, KFBF

**District Caucus Breakout**

**Issues Update**  
Rebeckah Adcock, Sr. Advisor to Secretary Perdue, USDA  
Chad Rupe, Administrator for Rural Utilities Service, USDA

12:15 PM **Mt. Vernon Tour**

12:45 PM **Museum of the Bible**

1:00 PM **International Spy Museum**

### SATURDAY'S SHUTTLE SCHEDULE

**Depart Washington Reagan Airport for JW Marriott**  
**Depart Baltimore Airport for JW Marriott**  
*Check informational email for instructions*

---

### SUNDAY'S SHUTTLE SCHEDULE

8:30 AM | 10:15 AM | 1:00 PM  
**Depart JW Marriott for Sponsored Tours | Pre-purchased**

---

### MONDAY'S SHUTTLE SCHEDULE

12:15 PM | 12:45 PM | 1:00 PM  
**Depart JW Marriott for Sponsored Tours | Pre-purchased**

## TUESDAY, FEBRUARY 25

- 7:30 AM **Breakfast with Kentucky's Delegation**  
Capitol Ballroom
- 9:45 AM **Meet Your Representative**  
District 1: JW Marriott, Ballroom  
District 2: JW Marriott, Ballroom  
District 3: JW Marriott, Ballroom  
District 4: JW Marriott, State Room  
District 5: Capitol Visitor Center (10:00 AM)  
District 6: JW Marriott, Treasury Room
- 11:30 AM **Lunch On Your Own**  
Union Station (Optional)
- 2:15 PM **Group Picture**  
Russell Senate Building Rotunda
- 3:00 PM **Q & A Session with Senators**  
Russell Senate Building, Kennedy Caucus Room
- 4:15 PM **Itinerary 2 | Baltimore Airport**  
Southwest Flight #1692
- 7:00 PM **Evening City Tour**

### TUESDAY'S SHUTTLE SCHEDULE

9:30 AM (*District 5 only*)

**Depart JW Marriott for the U.S. Capitol**

*There will be a good deal of walking*

11:30 AM

**Depart JW Marriott for Union Station**

*Transportation from Union Station on your own*

1:45 PM

**Depart JW Marriott for Peace Circle**

*Group Picture, Russell Senate Building Rotunda*

*There will be a good deal of walking*

CONCLUSION OF SENATE Q & A

**Depart for the JW Marriott**

*Meet at D Street and 1st Street*

4:15 PM (*Itinerary 2 only*)

**Depart JW Marriott for Baltimore Airport**

*Itinerary 2: Southwest Flight #1692*

*Check informational email for instructions*

7:00 PM

**Depart JW Marriott for Sponsored Tour | Pre-purchased**

## WEDNESDAY, FEBRUARY 26

No formal events are planned. Activity areas include sightseeing, or visiting a congressional committee meeting – if time permits.

- Checkout time is noon. Luggage can be stored in the hotel's luggage storage area until your departure.
- Pay your hotel balance upon checking out (if applicable).
- It is your responsibility to load your luggage on the bus for departure to the airport (KFB group flights only).
- Please remember your luggage must be unlocked for security inspection at the airport.
- Check airline websites for FAA travel regulations for your carry-on luggage.

4:45 AM **Itinerary 1 Departure | Baltimore Airport**  
Southwest Flight #1696

6:10 AM **Itinerary 5 Departure | Washington Reagan Airport**  
Delta Flight #4894

7:00 AM **Itinerary 4 Departure | Washington Reagan Airport**  
American Flight #5530

7:50 AM **Itinerary 3 Departure | Washington Reagan Airport**  
Southwest Flight #1178

### WEDNESDAY'S SHUTTLE SCHEDULE

4:45 AM (*Itinerary 1 only*)

**Depart JW Marriott for Baltimore Airport**

*Itinerary 1: Southwest Flight #1696*

*Check informational email for instructions*

6:10 AM (*Itinerary 5 only*)

**Depart JW Marriott for Washington Reagan Airport**

*Itinerary 5: Delta Flight #4894*

*Check informational email for instructions*

7:00 AM (*Itinerary 4 only*)

**Depart JW Marriott for Washington Reagan Airport**

*Itinerary 4: American Flight #5530*

*Check informational email for instructions*

7:50 AM (*Itinerary 3 only*)

**Depart JW Marriott for Washington Reagan Airport**

*Itinerary 3: Southwest Flight #1178*

*Check informational email for instructions*

# **KENTUCKY'S CONGRESSIONAL DELEGATION**

KFB-DC

02.22-26.20



Congressional Plan (CH302C02) become law (KRS 118B.110-118B.160)

February 10, 2012, with enactment of House Bill 302.

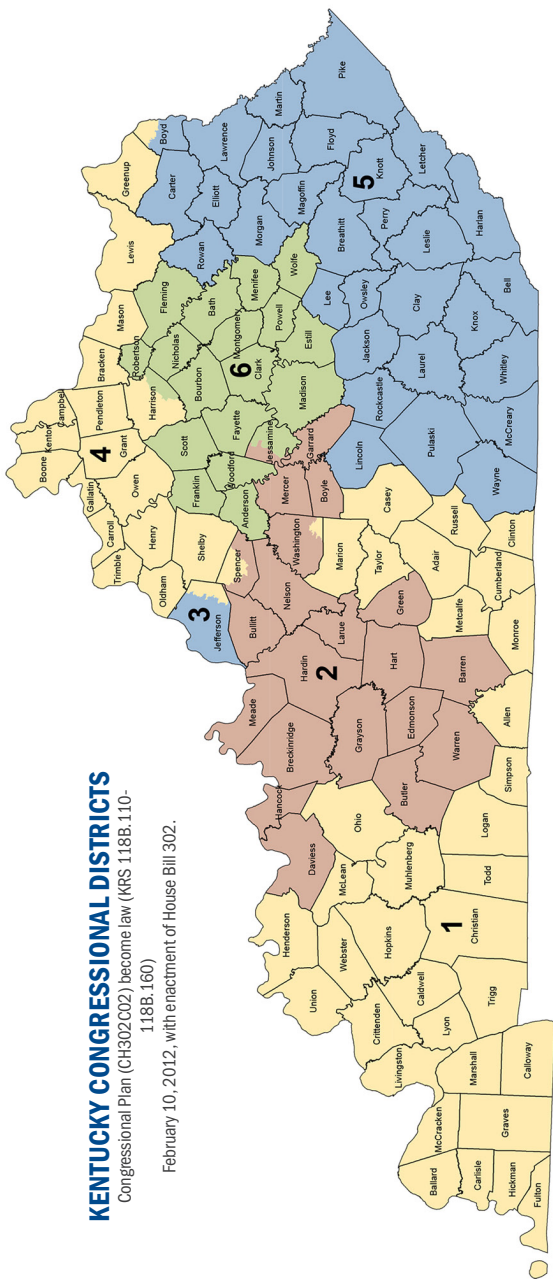

# UNITED STATES SENATORS

**The Honorable Mitch McConnell**

317 Russell Senate Office Building  
Washington, D.C. 20510  
Phone: 202-224-2541

**Committee Assignments:**

Senate Majority Leader  
Agriculture, Nutrition & Forestry Committee  
Appropriations Committee  
Intelligence Select Committee  
Rules & Administration Committee



**The Honorable Dr. Rand Paul**

167 Russell Senate Office Building  
Washington, D.C. 20510  
Phone: 202-224-4343

**Committee Assignments:**

Foreign Relations Committee  
Health, Education, Labor & Pensions Committee  
Homeland Security & Governmental Affairs Committee  
Small Business & Entrepreneurship Committee



---

# UNITED STATES REPRESENTATIVES

**District 1 | The Honorable James Comer**

1037 Longworth House Office Building  
Washington, D.C. 20515  
Phone: 202-225-3115

**Committee Assignments:**

Agriculture Committee  
Education & Labor Committee  
    Ranking Member, Civil Rights & Human Services Subcommittee  
Oversight and Reform Committee  
    Ranking Member, Environment Subcommittee



**District 2 | The Honorable Brett Guthrie**

2434 Rayburn House Office Building  
Washington, D.C. 20515  
Phone: 202-225-3501

**Committee Assignments:**

Energy & Commerce Committee  
    Ranking Member, Oversight & Investigations Subcommittee  
Education & Labor Committee



## UNITED STATES REPRESENTATIVES CONTINUED

### **District 3 | The Honorable John Yarmuth**

402 Cannon House Office Building  
Washington, D.C. 20515  
Phone: 202-225-5401

#### **Committee Assignments:**

Chair, Budget Committee



### **District 4 | The Honorable Thomas Massie**

2453 Rayburn House Office Building  
Washington, D.C. 20515  
Phone: 202-225-3465

#### **Committee Assignments:**

Oversight & Reform Committee  
Transportation & Infrastructure Committee



### **District 5 | The Honorable Harold Rogers**

2406 Rayburn House Office Building  
Washington, D.C. 20515  
Phone: 202-225-4601

#### **Committee Assignments:**

Appropriations Committee  
Ranking Member, State & Foreign Operations Subcommittee



### **District 6 | The Honorable Andy Barr**

2430 Rayburn House Office Building  
Washington, D.C. 20515  
Phone: 202-225-4706

#### **Committee Assignments:**

Financial Services Committee  
Ranking Member, Oversight & Investigations Subcommittee  
Veterans' Affairs Committee



# KFB NATIONAL PRIORITIES

KFB-DC

02.22-26.20

## NATIONAL FARM POLICY

- **Federal crop insurance programs should be maintained at current levels to provide an effective safety net for agriculture.**
- **Support crop insurance initiatives to maintain the integrity of crop insurance.**
- **Support NRCS assistance for the development of additional water resources for irrigation and livestock use.**
- **Support modifying USDA Rural Development broadband programs to increase access to broadband service that meets or exceeds FCC standards.**

The farm bill provides authorization for services and programs that impact every American and millions of people across the world. Farm bill programs are designed to provide farmers with the safety net to survive major natural disasters or adverse market factors. Timely and effective implementation of these programs is critical. Increasingly important to agriculture is strong investment in broadband programs that provide reliable, high speed broadband available for rural Americans to utilize.

---

## TRADE

- **Support fair and open multilateral trade agreements that will open new markets and expand existing markets for U.S. agricultural products.**

More than 20 percent of U.S. farm and food products are exported. It is critical that sound, multilateral international trade agreements are drafted that will help farmers compete globally on a level playing field to have access to the world's consumers, 95 percent of whom live outside our borders. To expand access to international markets, it is imperative that we work to reduce and eliminate international barriers to trade.

---

## INFRASTRUCTURE

- **Support maintenance and improvement of transportation infrastructure, including rural highways, lock and dam systems, riverports, and railroads.**

Development and maintenance of transportation infrastructure is essential in getting commodities to markets both domestically and abroad. Current U.S. infrastructure is a key advantage over many of our foreign competitors, and that advantage must be maintained.

## REGULATORY REFORM

- **Support a thorough regulatory review to ensure regulations do not impose an undue economic burden on any segment of society and the regulatory process is transparent and results achievable.**
- **All regulations should be based on sound, peer-reviewed scientific data that can be replicated.**
- **Support congressional oversight of federal agency regulatory actions to ensure rules and regulations do not exceed the intent and authority of federal law.**

Federal regulations have a direct impact on farmers and over the years the extent of the regulatory landscape has broadened. Burdensome regulations are recognized as a primary factor that slows economic growth and innovation. Waters of the United States (WOTUS), endangered and threatened species protection, pollinator protection, climate change, and farm labor are examples of areas in which far-reaching federal regulatory oversight is negatively impacting agriculture.

---

## IMMIGRATION & FARM LABOR REFORM

- **Support immigration reform that restructures the H-2A program to make it more streamlined, reliable, and economical, in addition to limiting legal liability for farmers.**

American agriculture has consistently experienced difficulties in finding and retaining adequate labor to produce the food, fiber, and energy our growing population needs. The current H-2A program needs reforms to make the program more simple, cost effective, and easier for farmers to use.

---

## HEALTH CARE REFORM

- **Support changes to current health care law that will stabilize the market, encourage competition that will reduce health care costs and increase consumer choice.**

For many farm families health insurance is the largest monthly payment. Lack of competition among providers in recent years has driven many premiums up. Efforts to address delivery of quality health care at a reasonable cost on the national level continues.

## FISCAL POLICY

- **In order to protect the future integrity of our nation's economy it is in our best interest to address budget deficits, which erode our ability to remain fiscally stable with the goal of reaching a balanced budget.**

Federal debt affects economic growth. Government spending currently accounts for around a fifth of economic activity in the U.S. This means more federal dollars are needed to service the debt with fewer dollars to build roads, continue needed federal programs, or provide tax incentives to spur business growth.

---

## WILDLIFE ISSUES

- **Support a producer's right to protect livestock and property against nuisance wildlife predation.**
- **Support a nationwide depredation order, or safe harbor provision, to take black vultures.**

Producers face crop and livestock losses from a multitude of wildlife species including black vultures, coyotes, feral hogs, deer, elk, and black bears. Protection of livestock and property against depredation is critical to a farmer's profitability.

# ADDITIONAL INFORMATION

KFB-DC

02.22-26.20



# HOSPITALITY

JW Marriott | Senate Room, Lobby Level

**Saturday, February 22** 9:00 AM - 5:00 PM

**Sunday, February 23** 8:00 AM - 5:00 PM

Sponsored by Kentucky Farm Bureau Federation and Kentucky Farm Bureau Mutual Insurance Company

---

## KFBF STAFF CONTACT INFORMATION

<u>First Name</u>	<u>Last Name</u>	<u>Phone</u>
Austin	Anderson	270-906-6477
B. Todd	Bright	502-489-2214
Emily	Buckman	502-718-1806
Joe	Cain	502-303-3663
Scott	Christmas	502-554-7862
Phil	Dowdle	502-287-8386
Katherine	Fugate	502-836-9557
Drew	Graham	859-771-6556
Christi	Harper	502-550-4494
Jeff	Harper	502-439-2101
Matt	Hilton	502-777-3798
Tony	Holloway	270-841-8457
Matt	Ingram	502-836-9358
Kelli	Jolly	502-356-5105
Tom	Logue	502-744-7844
Mark	Lyle	859-619-7423
Dave	Metzgar	502-810-8334
Stacy	Sipes	502-554-6076
Sara	Stivers	502-558-4521
Rachel	Thomas	502-554-6075
Tim	Thornberry	502-352-0300
Mike	Tobin	859-340-0179
Billy	Toombs	859-396-6704
Matt	Wilson	270-804-8758

---

## HOTEL INFORMATION

JW Marriott  
1331 Pennsylvania Avenue NW  
202-393-2000

# HOTEL FLOOR PLAN

## Lobby Level

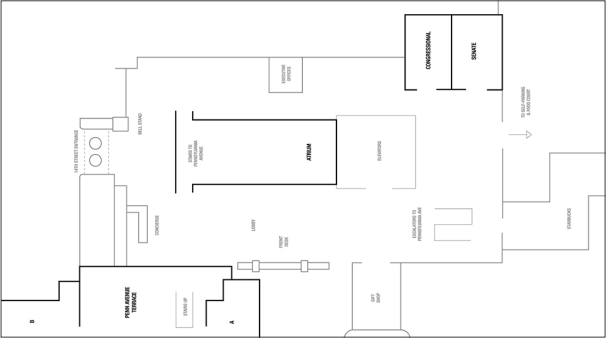

## Meeting Room Level



## Ballroom Level

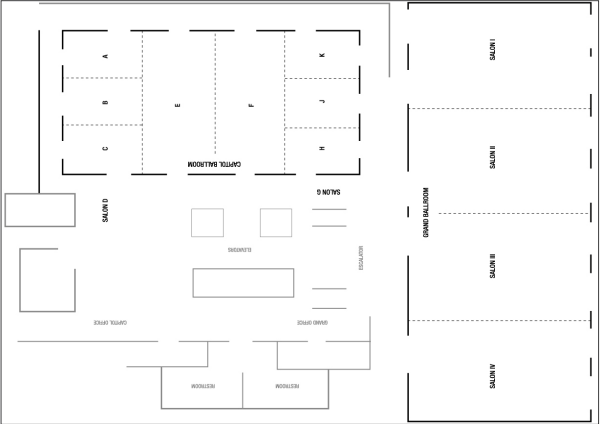

NOTES:



**KENTUCKY FARM BUREAU**  
**KFB100YEARS**  
— EST. 1919 —